



Chlamydia and gonorrhoea swab collection

Vaginal swab specimen-self-collection

Note: Collection of an adequate specimen and maintenance of specimen integrity prior to testing have a direct influence on the reliability of results. If the doctor specifically requests for patient self-collection (low vaginal swab), give the patient a collection kit and ensure the patient has read and understood the following self-collection instructions; otherwise collection staff are to perform this procedure in the collection centre.

Preparation

1. Undress to expose the vaginal area.
2. Put yourself in a comfortable position.
3. Remove the collection tube and swabs from the collection kit.
4. Discard the larger cotton tipped swab.
5. For collection instructions, please see overleaf.

Handling precautions

- Do not pre-wet collection swab with the collection media or any other liquid before obtaining the vaginal sample.
- Use care to avoid splashing contents of the tube. If the contents of the tube are spilled on your skin, wash the affected area with soap and water. If the contents of the tube splash into your eyes, flush them with water immediately. Always notify your healthcare provider.



Chlamydia and gonorrhoea swab collection



- 1. Position:** Hold the swab in one hand and, with the other hand, separate the folds of skin around the vaginal opening (labia).



- 2. Collect:** Insert the swab about 5 cm (2 inches) into the vaginal opening. Gently turn the swab for about 30 seconds while rubbing the swab against the wall of the vagina. Remove the swab carefully. Do not touch the swab to any surface before placing it into the collection tube.

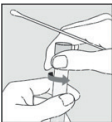

- 3. Open tube:** While holding the swab in the same hand, remove the cap from the tube, as shown in the diagram.

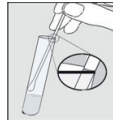

- 4. Align:** Lower the swab into the tube until the visible dark line on the swab shaft is lined up with the tube rim. The tip of the swab should be just above the liquid in the tube.

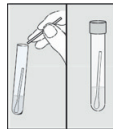

- 5. Break:** Carefully lean the swab against the tube rim to break the swab shaft at the dark line; discard the top portion of the swab.

- 6. Close:** Tightly close the cobas® PCR Media tube. Return the sample to your healthcare provider as instructed.